

**Restroom Options**  
(Not To Scale)

225 Liter Barrels:  
 Single Stack - 172 Barrels  
 Double Stack - 344 Barrels  
 Triple Stack - 516 Barrels  
 2.5" Maximum Between Wall and Barrels.  
 3'6" Between Barrels.

225 Liter Barrels:  
 Single Stack - 72 Barrels  
 Double Stack - 144 Barrels  
 Triple Stack - 216 Barrels  
 1' Between Wall and Barrels  
 5'-6" Between Barrels

225 Liter Barrels:  
 Single Stack - 172 Barrels  
 Double Stack - 344 Barrels  
 Triple Stack - 516 Barrels  
 6" Maximum Between Wall and Barrels.  
 3'4" Between Barrels.

225 Liter Barrels:  
 Single Stack - 104 Barrels  
 Double Stack - 208 Barrels  
 Triple Stack - 312 Barrels  
 6" Between Wall and Barrels  
 6'-6" Between Barrels

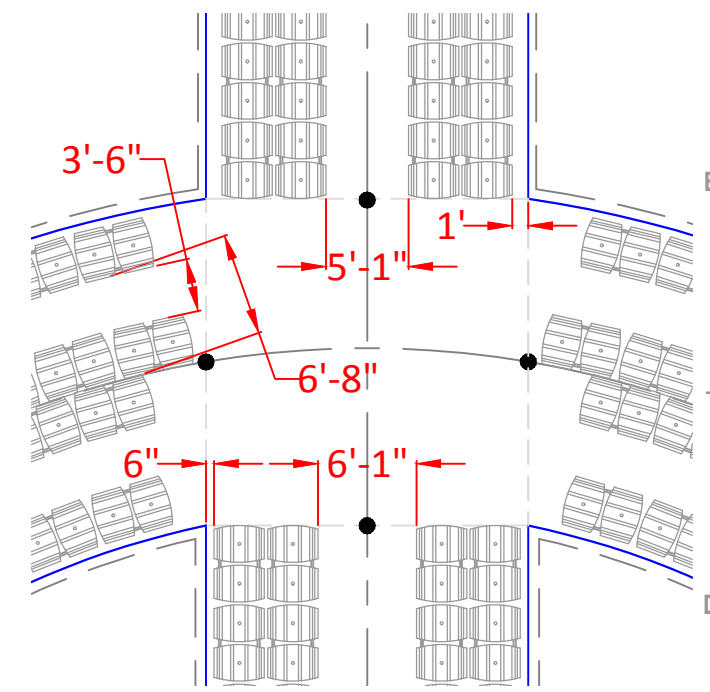

**Intersection A-2**  
(Not To Scale)

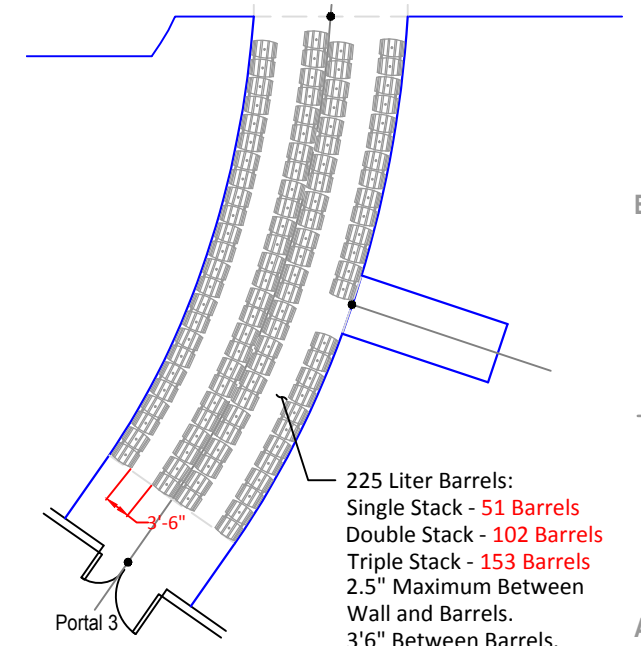

**Optional Placement of**  
225 Liter Barrels

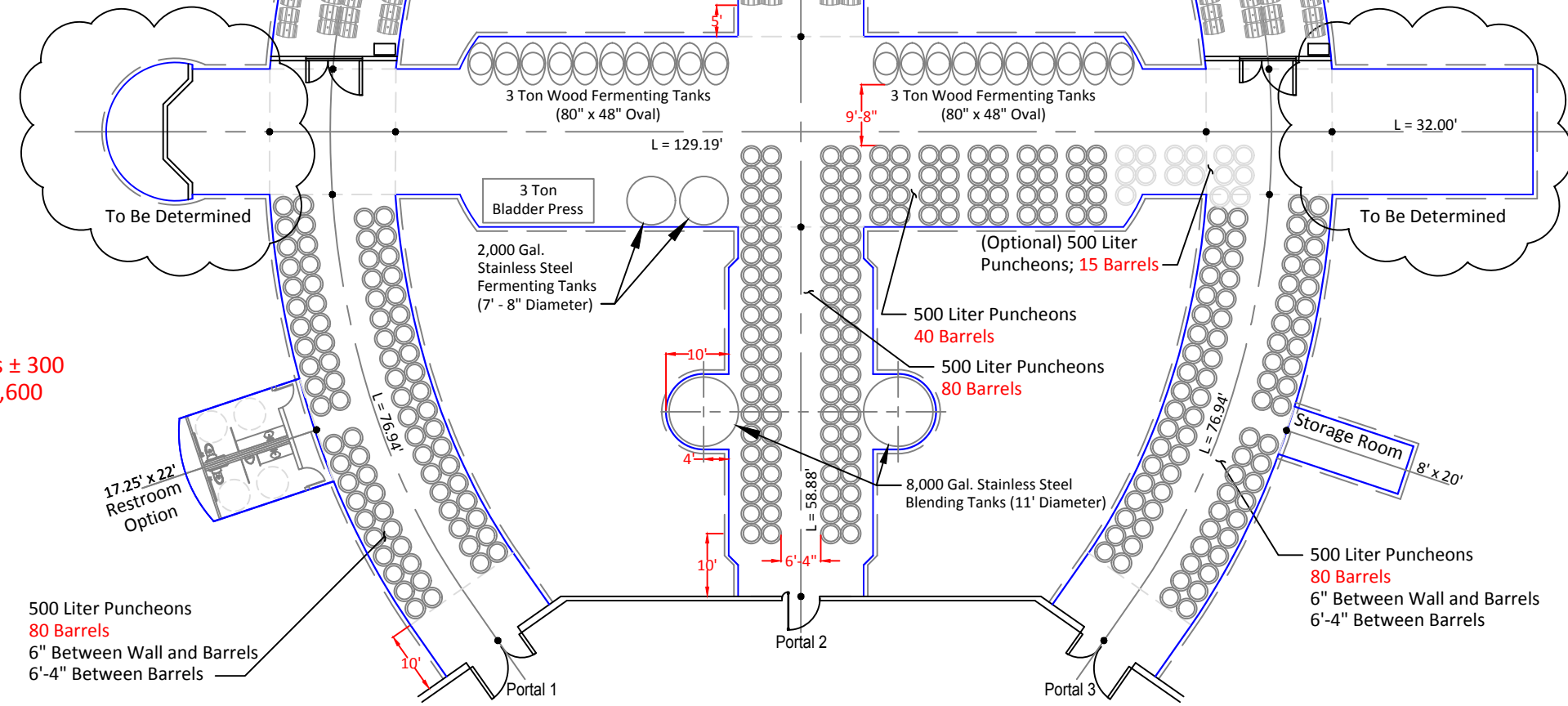

**TOTALS:**  
 500L Puncheons ± 300  
 225L Barrels ± 1,600

**Total Square Footage = 18,082.57 ft<sup>2</sup>**

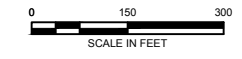

REVISIONS	
REV	DATE DESCRIPTION

SHEET DATA	
FILE: Generic_CavePlan-MMS01	
DRAWN BY: D. HADA	DATE: 10-21-2015
CHECKED BY:	DATE:
SCALE: As Shown	

All ideas, designs, arrangements and plans indicated or represented by these drawings are owned by, and the property of, Magorian Mine Services and were created and developed for use, and in conjunction with, the specific project described herein. None of these ideas, designs and arrangements or plans shall be used by, or disclosed to any person, firm, or corporation for any purpose without permission of Magorian Mine Services. Filing these drawings with a public agency is not a publication of same, and no copying, reproduction or use thereof is permissible without the consent of Magorian Mine Services. Visual contact with these plans and specifications shall constitute prima facie evidence of the acceptance of these restrictions. Contractors shall verify all dimensions, notes, and specifications in these drawings. If any variation, discrepancy or omission is discovered, contractor shall notify Magorian Mine Services. Prior to proceeding with any related work and obtain a written response from Magorian Mine Services.

TITLE	
<b>Cave Plan</b>	

SHEET NUMBER	
<b>MMS-01</b>	

**CAVE PLAN**

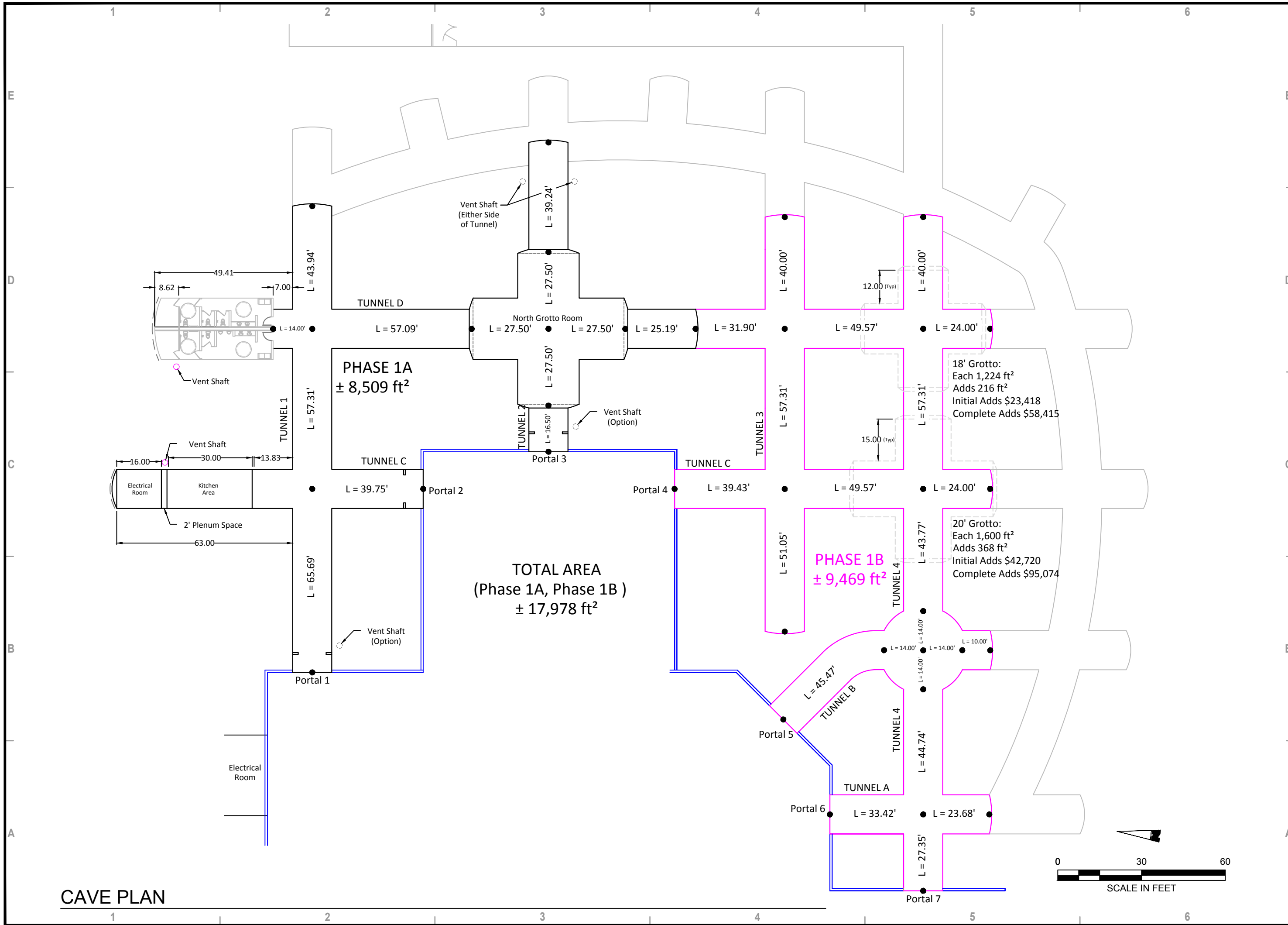

PROJECT

REVISIONS

REV	DATE	DESCRIPTION

SHEET DATA

FILE: CavePlan\_MMS02  
 DRAWN BY: D. HADA DATE: 6-23-2016  
 CHECKED BY: DATE:  
 SCALE: As Shown

All ideas, designs, arrangements and plans indicated or represented by these drawings are owned by, and the property of, Magorian Mine Services and were created and developed for use, and in conjunction with, the specific project described herein. None of these ideas, designs and arrangements or plans shall be used by, or disclosed to any person, firm, or corporation for any purpose without permission of Magorian Mine Services. Filing these drawings with a public agency is not a publication of same, and no copying, reproduction or use thereof is permissible without the consent of Magorian Mine Services. Visual contact with these plans and specifications shall constitute prima facie evidence of the acceptance of these restrictions. Contractors shall verify all dimensions, notes, and specifications in these drawings. If any variation, discrepancy or omission is discovered, contractor shall notify Magorian Mine Services. Prior to proceeding with any related work and obtain a written response from Magorian Mine Services.

TITLE  
**Cave Plan**

SHEET NUMBER  
**MMS 02**  
 Sheet 1 of 1

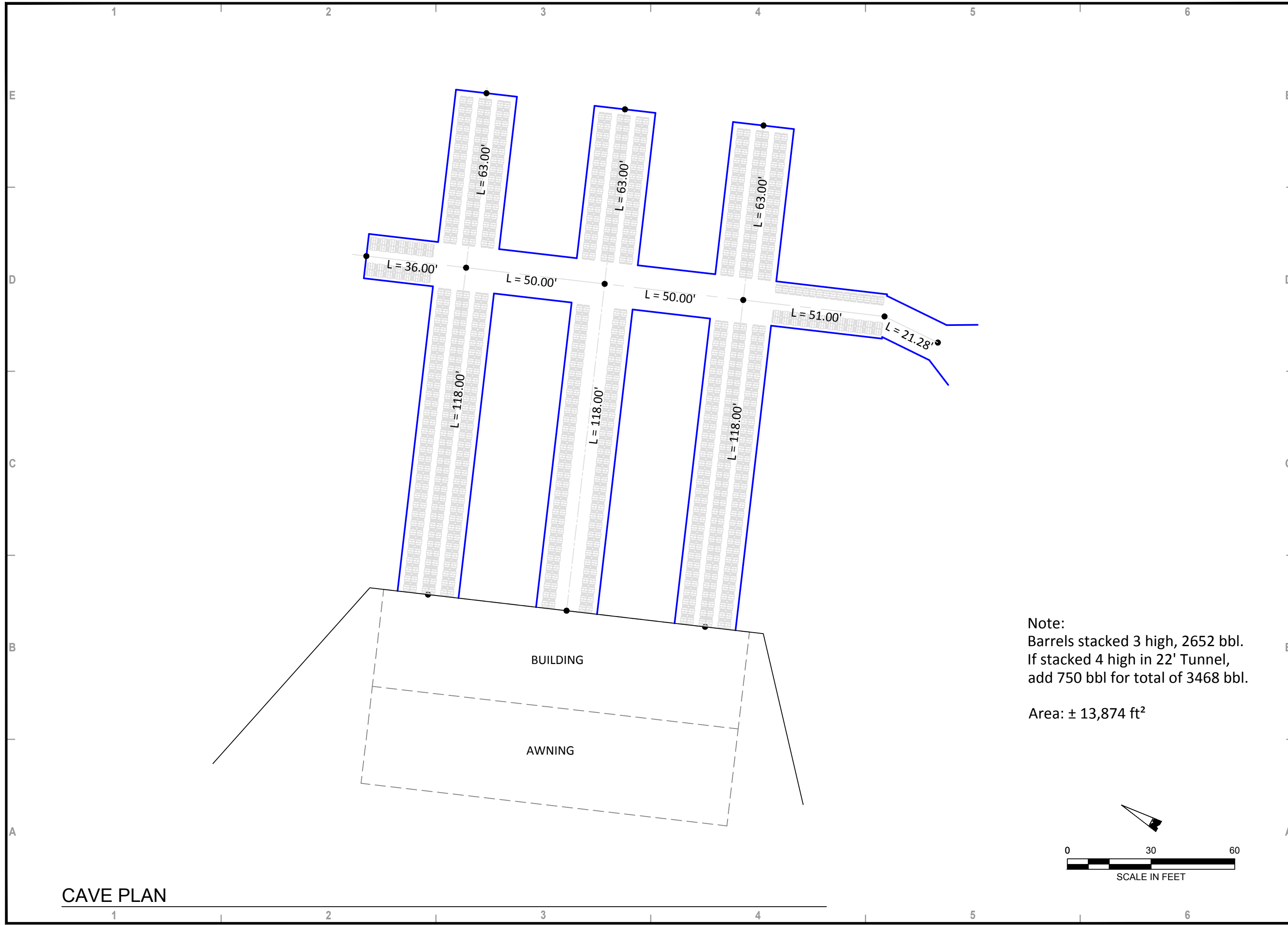

Note:  
 Barrels stacked 3 high, 2652 bbl.  
 If stacked 4 high in 22' Tunnel,  
 add 750 bbl for total of 3468 bbl.

Area: ± 13,874 ft<sup>2</sup>

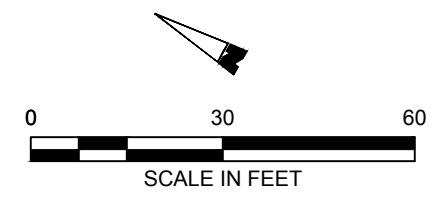

**CAVE PLAN**

PROJECT

REVISIONS

REV	DATE	DESCRIPTION

SHEET DATA

FILE: CavePlan_MMS03	DATE: 6-29-2016
DRAWN BY: D. HADA	CHECKED BY:
SCALE: As Shown	

All ideas, designs, arrangements and plans indicated or represented by these drawings are owned by, and the property of, Magorian Mine Services and were created and developed for use, and in conjunction with, the specific project described herein. None of these ideas, designs and arrangements or plans shall be used by, or disclosed to any person, firm, or corporation for any purpose without permission of Magorian Mine Services. Filing these drawings with a public agency is not a publication of same, and no copying, reproduction or use thereof is permissible without the consent of Magorian Mine Services. Visual contact with these plans and specifications shall constitute prima facie evidence of the acceptance of these restrictions. Contractors shall verify all dimensions, notes, and specifications in these drawings. If any variation, discrepancy or omission is discovered, contractor shall notify Magorian Mine Services. Prior to proceeding with any related work and obtain a written response from Magorian Mine Services.

TITLE

**Cave Plan**

SHEET NUMBER

**MMS 03**

Sheet 1 of 1

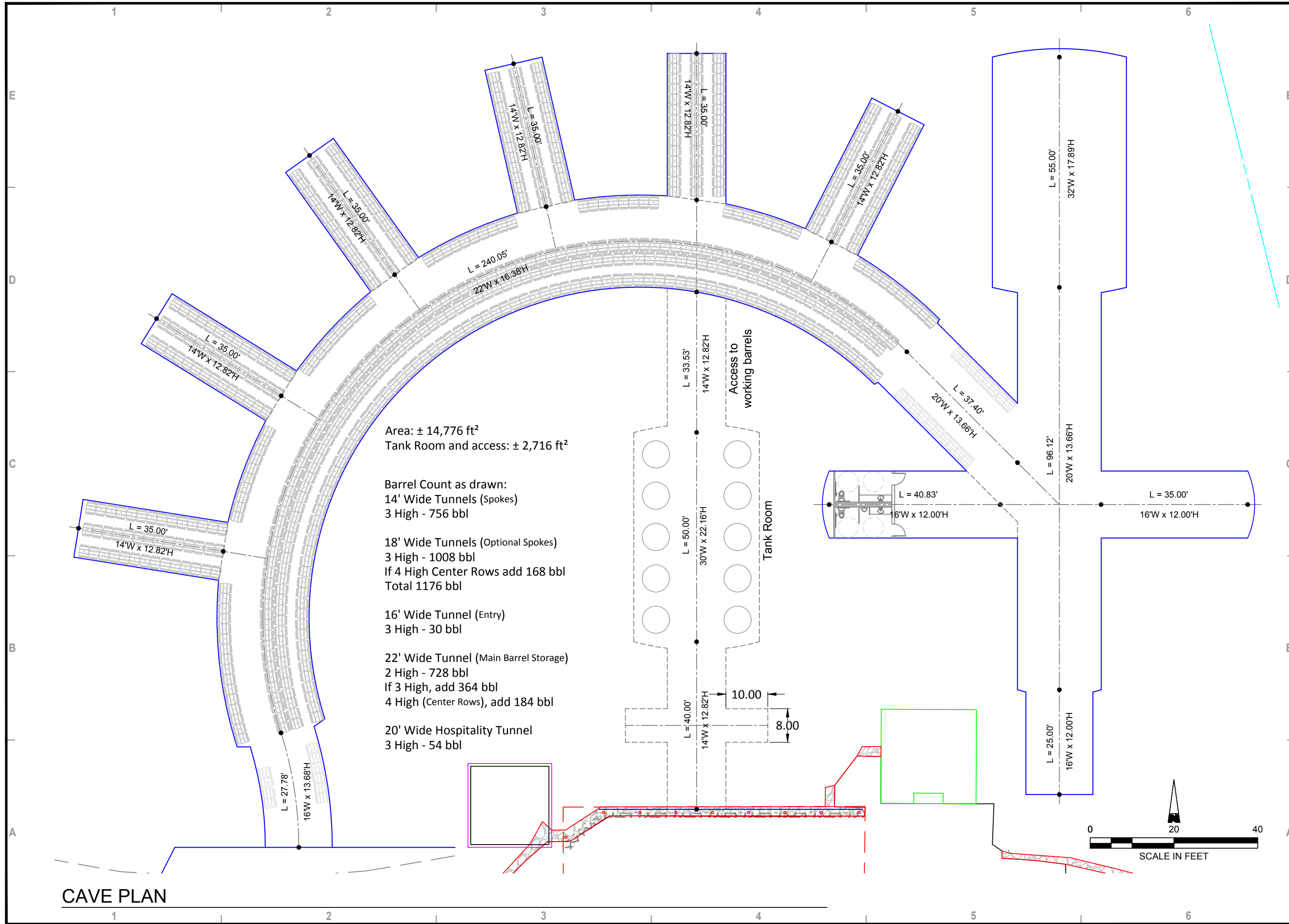

PROJECT

REVISIONS

REV	DATE	DESCRIPTION

SHEET DATA

FILE: CavePlan_MMS05	DATE: 6-6-2017
DRAWN BY: D. HADA	CHECKED BY:
SCALE: As Shown	DATE:

All ideas, designs, arrangements and plans indicated or represented by these drawings are owned by, and the property of, Magorian Mine Services and were created and developed for use, and in conjunction with, the specific project described herein. None of these ideas, designs and arrangements or plans shall be used by, or disclosed to any person, firm, or corporation for any purpose without permission of Magorian Mine Services. Filing these drawings with a public agency is not a publication of same, and no copying, reproduction or use thereof is permissible without the consent of Magorian Mine Services. Visual contact with these plans and specifications shall constitute prima facie evidence of the acceptance of these restrictions. Contractors shall verify all dimensions, notes, and specifications in these drawings. If any variation, discrepancy or omission is discovered, contractor shall notify Magorian Mine Services. Prior to proceeding with any related work and obtain a written response from Magorian Mine Services.

TITLE

**Cave Plan  
 With Barrels**

SHEET NUMBER

**MMS\_05**

Sheet 1 of 1

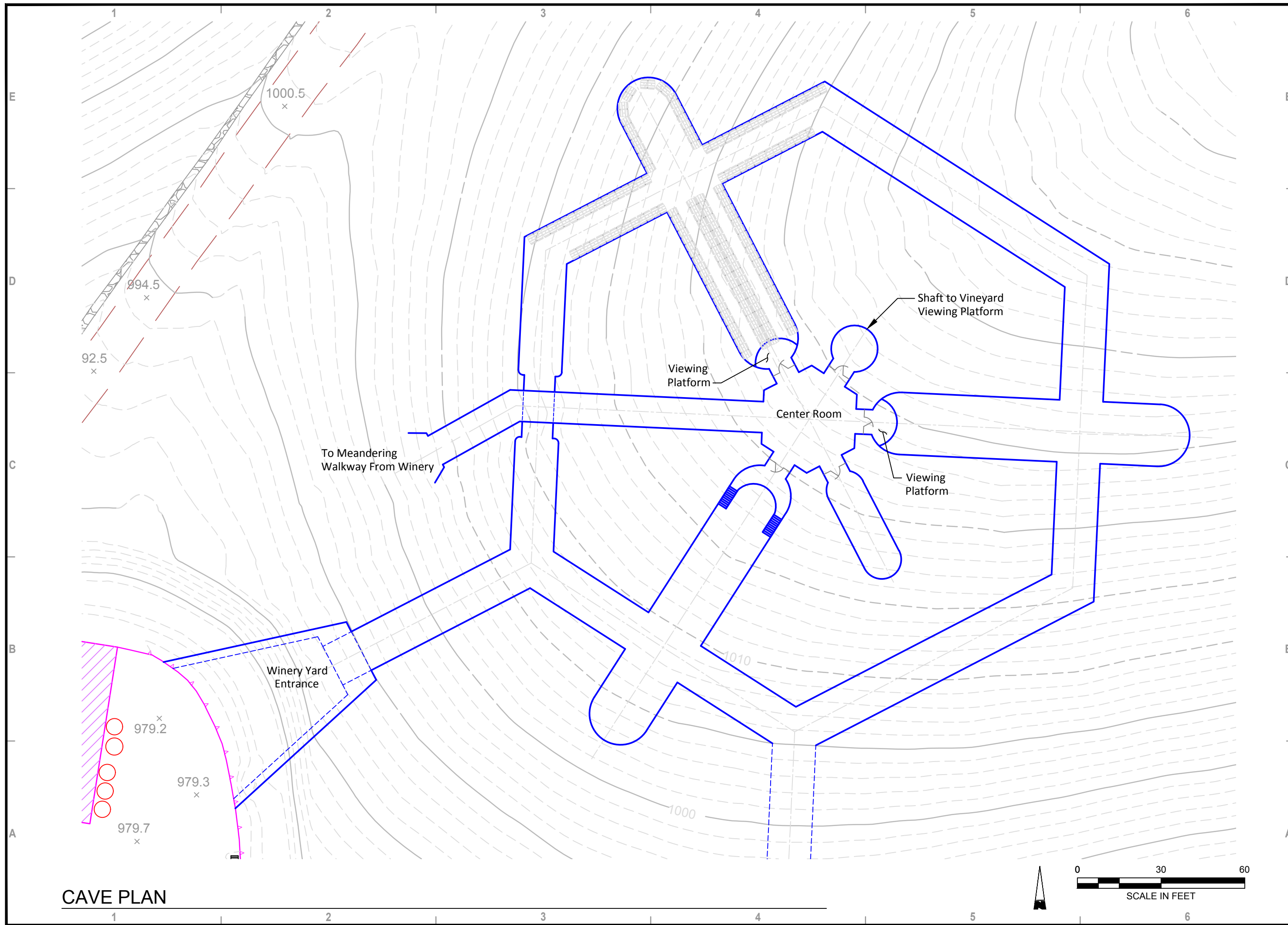

PROJECT

REVISIONS

REV	DATE	DESCRIPTION

SHEET DATA

FILE: CavePlan-MMS06
DRAWN BY: D. HADA      DATE: 6-6-2017
CHECKED BY:              DATE:
SCALE: As Shown

All ideas, designs, arrangements and plans indicated or represented by these drawings are owned by, and the property of, Magorian Mine Services and were created and developed for use, and in conjunction with, the specific project described herein. None of these ideas, designs and arrangements or plans shall be used by, or disclosed to any person, firm, or corporation for any purpose without permission of Magorian Mine Services. Filing these drawings with a public agency is not a publication of same, and no copying, reproduction or use thereof is permissible without the consent of Magorian Mine Services. Visual contact with these plans and specifications shall constitute prima facie evidence of the acceptance of these restrictions. Contractors shall verify all dimensions, notes, and specifications in these drawings. If any variation, discrepancy or omission is discovered, contractor shall notify Magorian Mine Services. Prior to proceeding with any related work and obtain a written response from Magorian Mine Services.

TITLE

**Cave Plan**

SHEET NUMBER

**MMS\_06**

Sheet 1 of 1

**CAVE PLAN**

Y: \Magorian Mines\Projects\07\_CAD\CavePlans\Generic\_CavePlan-MMS06.dwg 6-06-17