

DISNEY'S GRAND CALIFORNIAN HOTEL® & SPA FLOOR PLANS SEQUOIA BALLROOM

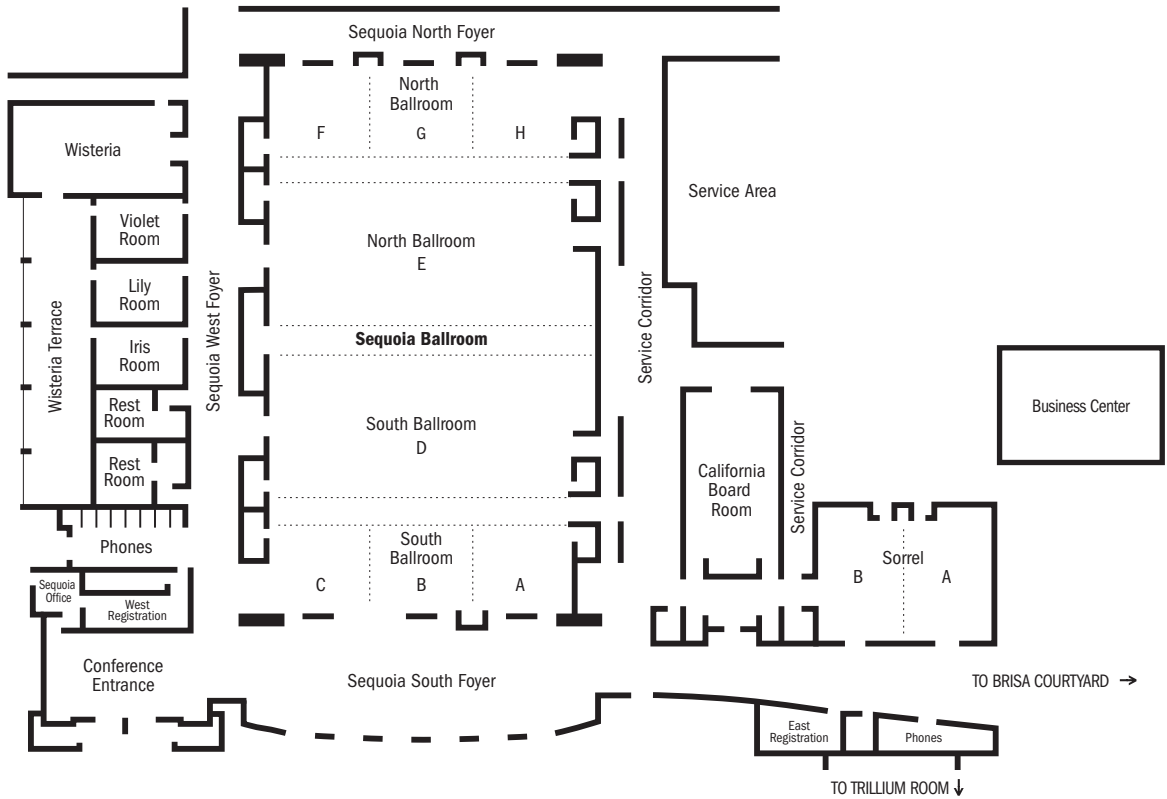

ROOM	THEATER	SCHOOLROOM	U-SHAPE	CONFERENCE	BANQUET	RECEPTION	W X L	SQ. FT.	CEILING HT.
SEQUOIA BALLROOM	1,200	800	—	—	840	1,700	85' x 144'	11,900	23'
SEQUOIA NORTH BALLROOM (1/2)	600	400	—	—	420	836	85' x 72'	5,850	23'
SEQUOIA SOUTH BALLROOM (1/2)	600	400	—	—	420	836	85' x 72'	5,850	23'
SEQUOIA A, B & C	210	120	48	52	120	359	88' x 24'	2,510	23'
SEQUOIA A	70	40	14	16	40	49	33' x 24'	630	23'
SEQUOIA B	70	40	14	16	40	49	27' x 24'	630	23'
SEQUOIA C	70	40	14	16	40	49	26' x 24'	630	23'
SEQUOIA D	320	250	—	—	220	474	37' x 85'	3,315	23'
SEQUOIA E	320	250	—	—	220	474	38' x 85'	3,315	23'
SEQUOIA F, G & H	210	120	48	52	120	359	80' x 24'	2,510	23'
SEQUOIA F	70	40	14	16	40	49	26' x 24'	630	23'
SEQUOIA G	70	40	14	16	40	49	27' x 24'	630	23'
SEQUOIA H	70	40	14	16	40	49	26' x 24'	630	23'
SEQUOIA SOUTH FOYER	—	—	—	—	—	331	—	2,315	12' – 24'9"
WISTERIA ROOM	120	66	28	30	70	160	24' x 47'	1,115	20'6"
IRIS ROOM	40	24	14	16	20	49	15' x 22'	370	12'
LILY ROOM	40	24	14	16	20	49	15' x 22'	370	12'
VIOLET ROOM	40	24	14	16	20	49	15' x 22'	370	12'
CALIFORNIA BOARD ROOM (Curved Ceiling)	—	—	—	24*	—	—	25' x 46'	1,080	10' – 19'
SORREL ROOM (Coffered Ceiling)	168	84	40	44	120	180	48' x 34'	1,610	12' – 13'6"
SORREL A	70	50	16	20	50	90	24' x 34'	795	12' – 13'6"
SORREL B	70	50	16	20	50	90	24' x 34'	800	12' – 13'6"

Listed capacities do not include audio visual or other additional equipment.

\* Using existing executive chairs. With use of banquet chairs, seating capacity is 30.

DISNEY'S GRAND CALIFORNIAN HOTEL® & SPA FLOOR PLANS TRILLIUM AND BRISA COURTYARD

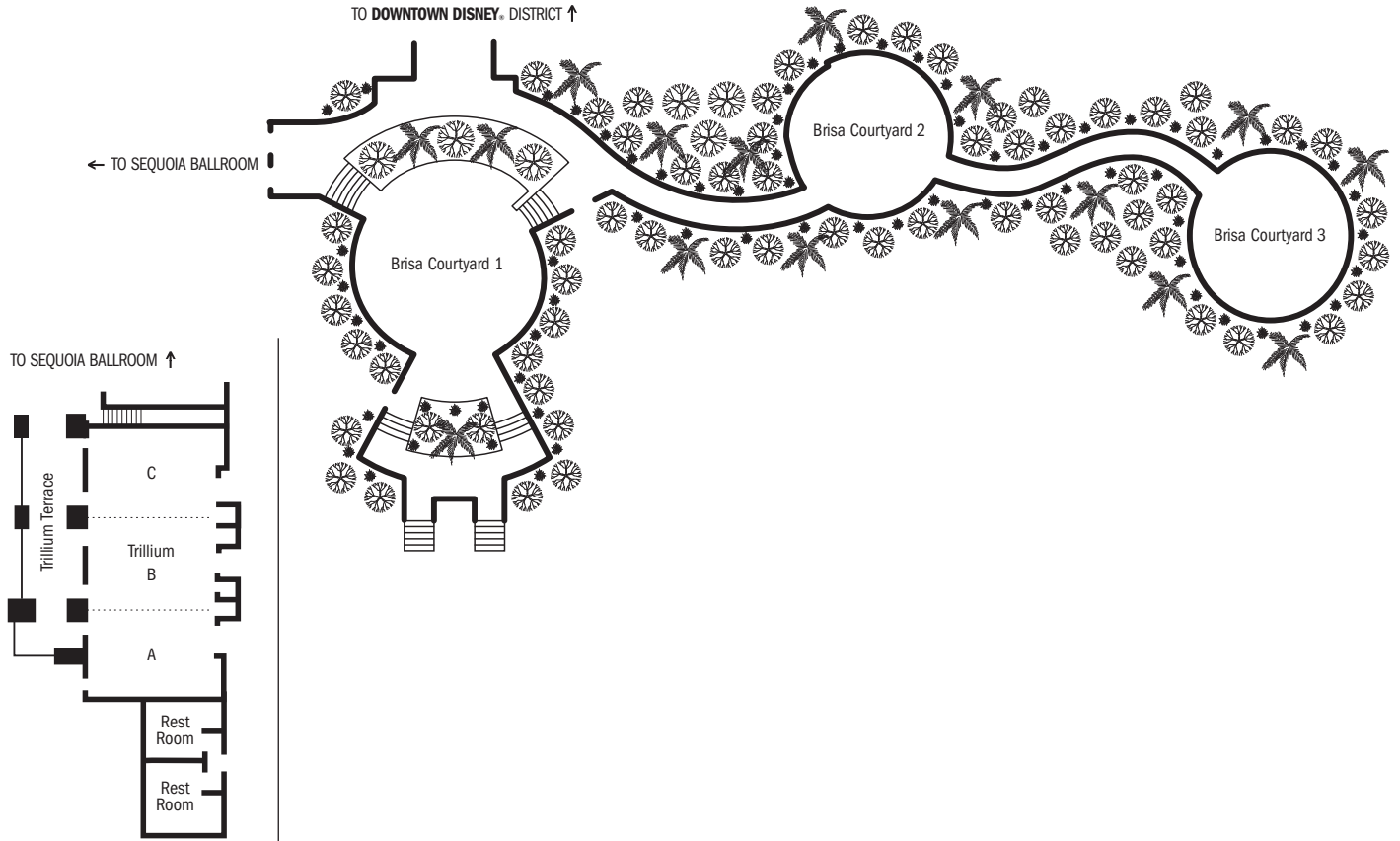

ROOM	THEATER	SCHOOLROOM	U-SHAPE	CONFERENCE	BANQUET	RECEPTION	W X L	SQ. FT.	CEILING HT.
TRILLIUM ROOM	300	180	40	60	180	360	76' x 34'	2,695	12'6"
TRILLIUM A	100	60	20	22	60	120	25' x 34'	875	12'6"
TRILLIUM B	100	60	20	22	60	120	27' x 34'	900	12'6"
TRILLIUM C	100	60	20	22	60	120	24' x 34'	885	12'6"
BRISA COURTYARD 1	—	—	—	—	12 ROUNDS	200	—	—	—
BRISA COURTYARD 2	—	—	—	—	8 ROUNDS	140	—	—	—
BRISA COURTYARD 3*	—	—	—	—	9 ROUNDS	160	—	—	—
PARKVIEW TERRACE	—	—	—	—	—	100	—	—	—

\* Brisa Courtyard should be used in its entirety.