



PACIFIC PALMS RESORT
GOLF · CONFERENCE CENTER · SPA

LIFESTYLE
Preferred
HOTELS & RESORTS

Golf Reservations - Tel: 626-810-4653



● Eisenhower Course ● Zaharias Course

R Restrooms

B Barbeque





MEZZANINE LEVEL

★ Elevators to guest room floors

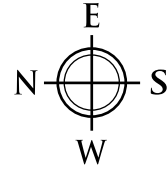

LOBBY LEVEL

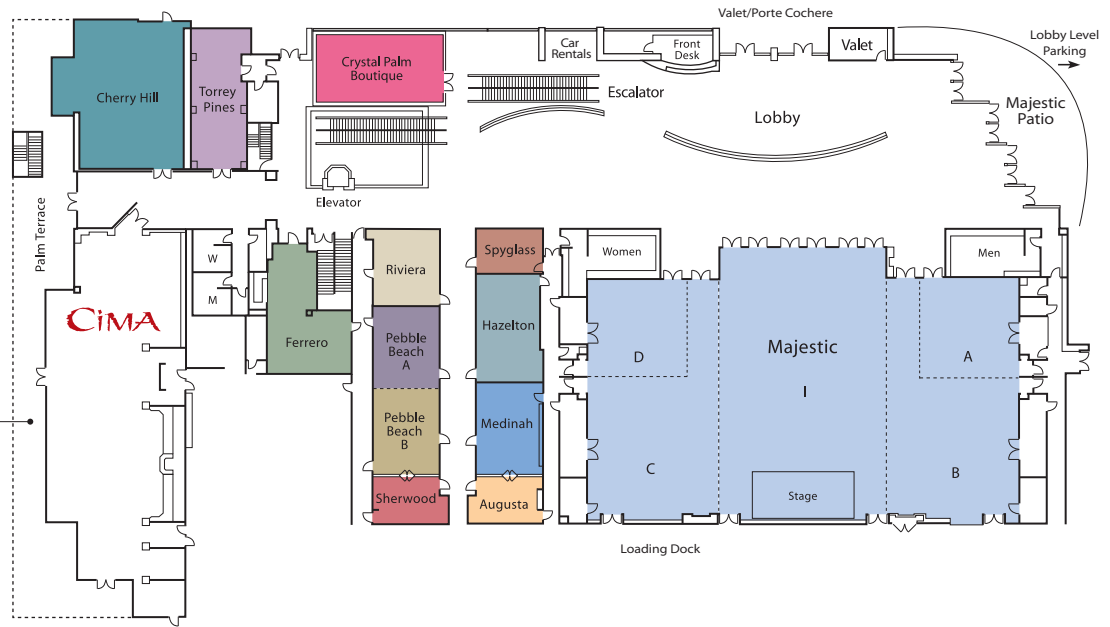

GARDEN LEVEL

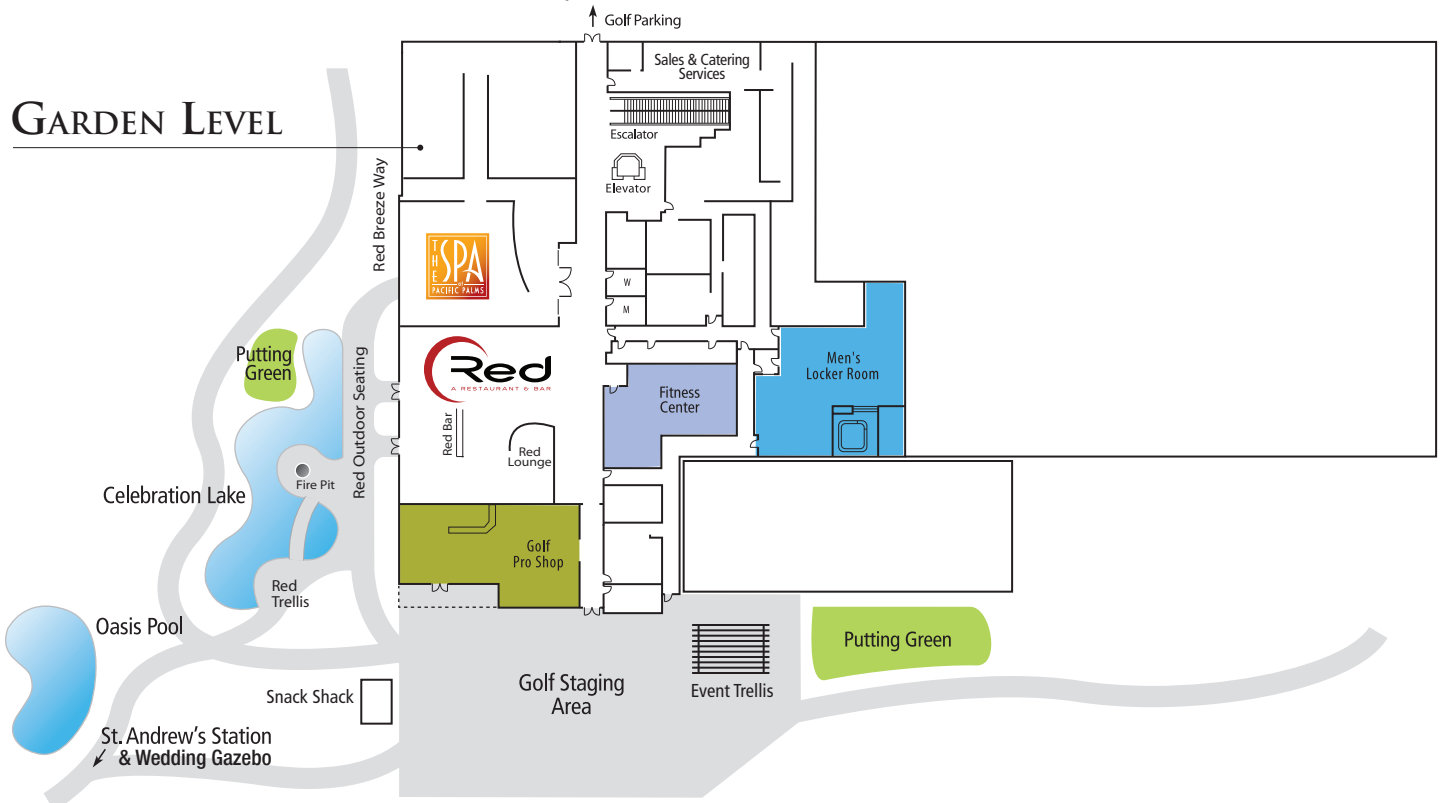

St. Andrew's Station & Wedding Gazebo

LOBBY LEVEL CAPACITIES

Specific Room	Dimensions L x W x H	Total Sq. Ft.	Theatre	Classroom*	Conference	U-shape*	Cluster	Rounds	Reception
Cherry Hill	40 x 60	2400	115	92/ 90	48	50 / 42	72	144	200
Torrey Pines	40 x 20 x 8	800	42	32/ 30	24	30 / 20	30	60	40
Ferrero	25 x 25 x 9	625	40	40/24	16	26 / 16	24	40	40
Riviera	21 x 25 x 10	525	40	24 / 18	20	24 / 16	24	30	30
Pebble Beach A & B	23 x 60 x 10	1,380	120	52 / 46	40	50 / 34	48	100	120
Pebble Beach A	23 x 28 x 10	644	50	32 / 24	24	20 / 18	24	40	50
Pebble Beach B	23 x 28 x 10	644	50	32 / 24	24	20 / 18	24	40	50
Sherwood	16 x 21 x 9	336	15	NA / 8	10	N/A	8	6	10
Spyglass	12 x 21 x 9	252	16	9 / 12	12	9 / 10	12	6	20
Hazelton	23 x 44 x 9	1,012	80	40/34	28	36 / 24	30	60	60
Medinah	23 x 30 x 10	690	60	32/24	24	20 / 16	24	40	50
Augusta	16 x 21 x 8	336	15/20	12 / 8	10	10 / N/A	6	10	10
Majestic I	61 x 91 x 26	5,551	450	280/252	N/A	N/A	216	360	450
Majestic A	35 x 33 x 22	1,155	90	60 / 40	36	40 / 26	54	70	60
Majestic B	43 x 47 x 22	2,021	150	100/78	48	60 / 36	72	140	150
Majestic C	43 x 47 x 22	2,021	150	100/78	48	40 / 36	72	140	150
Majestic D	35 x 33 x 22	1,155	90	60/40	36	60 / 26	54	70	60
Majestic Ballroom	147 x 80 x 26	11,760	1,350	770 / 448	N/A	N/A	N/A	930	1800
Majestic A & B	43 x 80 x 22	3,440	300	200 / 132	72	110 / 60	144	260	288
Majestic C & D	43 x 80 x 22	3,440	300	200 / 132	72	110 / 60	144	260	288

*Banquet Style Chairs and Tables/IACC Approved Ergonomic Chairs and Meeting Tables (Classroom & U-Shape Set-up)

MEZZANINE LEVEL CAPACITIES

Specific Room	Dimensions L x W x H	Total Sq. Ft.	Theatre	Classroom*	Conference	U-shape*	Cluster	Rounds	Reception
Colonial A	53 x 60 x 12	3,180	198	192 / 112	64	60 / 48	96	200	200
Colonial B	27 x 60 x 12	1,620	117	60 / 56	48	42 / 40	48	80	200
Colonial A & B	60 x 80 x 12	4,800	306	240 / 192	N/A	54 / 50	168	350	240
Pavilion	60 x 153 x 18	9,180	504	N/A	N/A	N/A	N/A	450	600
Bandon Dunes	18 x 24 x 9	432	25	20 / 12	16	20 / 14	12	20	15
Pacific Dunes	18 x 25 x 9	450	30	12 / 12	16	12 / 12	12	20	25
Pine Valley	27 x 54 x 9	1,458	100	50 / 34	32	40 / 28	36	80	100
Congressional	20 x 33 x 9	660	43	32 / 32	24	36 / 20	36	50	40
Valencia	21 x 29 x 9	609	30	30 / 22	24	20 / 20	24	30	40
Sedona	21 x 32 x 9	672	33	32 / 24	20	20 / 16	24	24	40
Inverness	18 x 29 x 9	522	24	20 / 16	16	20 / 14	18	20	30
Spanish Bay	18 x 21.5 x 9	387	21	12 / 16	12	12 / 12	12	20	30
Sandpiper	16 x 29 x 9	464	25	20 / 16	12	20 / 14	12	20	30

*Banquet Style Chairs and Tables/IACC Approved Ergonomic Chairs and Meeting Tables (Classroom & U-Shape Set-up)